

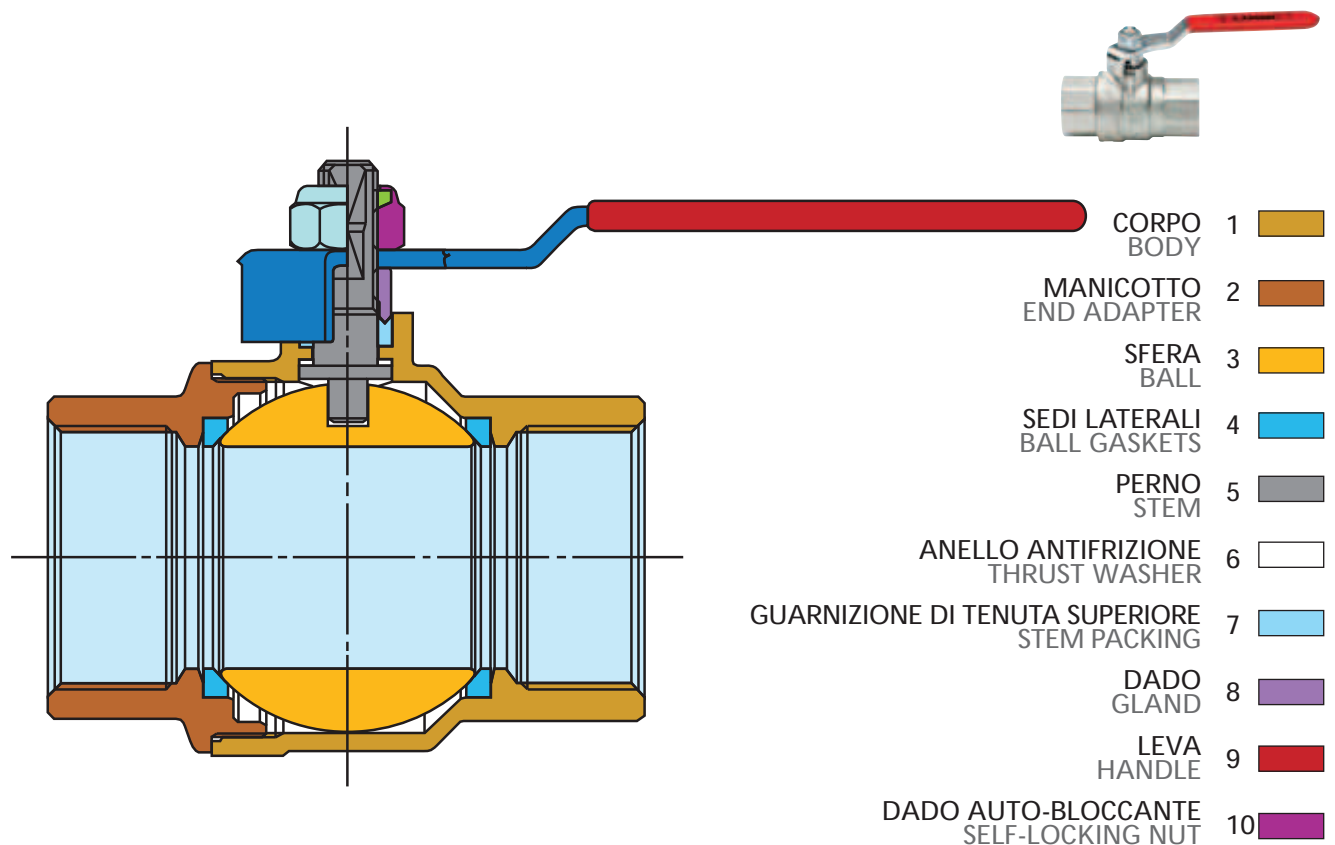











LOGIC

Valvola a sfera a passaggio totale serie pesante
Heavy line full bore ball valve



SPECIFICA MATERIALI / MATERIAL SPECIFICATION

PARTICOLARI / COMPONENT	MATERIALI / MATERIAL	DESCRIZIONE / DESCRIPTION
 1 Corpo Body	CW 617 N UNI EN 12165 CW 617 N UNI EN 12165	Stampato da barra, nichelato Nickel-plated, forged brass
 2 Manicotto End adapter	CW 617 N UNI EN 12165 CW 617 N UNI EN 12165	Stampato da barra, nichelato Nickel-plated, forged brass
 3 Sfera Ball	CW 614 N UNI EN 12164 CW 614 N UNI EN 12164	Da barra, nichel-cromata Machined brass bar, chrome-plated
 4 Sedi laterali Ball gaskets	P.T.F.E. P.T.F.E.	Vergine Pure Teflon
 5 Perno Stem	CW 614 N UNI EN 12164 CW 614 N UNI EN 12164	Da barra, nichelato Machined brass bar, nickel-plated
 6 Anello antifrizione Thrust washer	P.T.F.E. P.T.F.E.	Vergine Pure Teflon
 7 Guarnizione di tenuta superiore Stem packing	P.T.F.E. P.T.F.E.	Vergine Pure Teflon
 8 Dado Gland	CW 614 N UNI EN 12164 CW 614 N UNI EN 12164	Da barra Machined brass bar
 9 Leva Handle	Acciaio zincato Steel Fe P02	Plasticata P.V.C. rossa Zinc-plated, red P.V.C. insulated
 9 Leva o farfalla Lever or T-handle	AL UNI5076 AL UNI5076	Plasticata rossa Red polyurethane-coated aluminium
 10 Dado auto-bloccante Self-locking nut	Acciaio 8G Zinc-plated 8G steel	Acciaio zincato Zinc-plated

CARATTERISTICHE

Serie pesante, passaggio totale, filetti lunghi.
Tenuta perfetta a bassa e alta pressione.
Lunga durata senza manutenzione.

FILETTATURE

Estremità filettate UNI EN 10226 (ex UNI 7/1).

IMPIEGHI

Le valvole a sfera **LOGIC** sono adatte per l'uso con acqua calda e fredda, aria compressa, olii e idrocarburi in generale.

Per utilizzi speciali vedere le tabelle di compatibilità chimica.

PRESSIONE DI ESERCIZIO

Da PN 80 (1/4") a PN 16 (4").

Vedere diagramma pressione/temperatura.

LIMITI DI TEMPERATURA

-20°C + 140°C.

Vedere diagramma pressione/temperatura.

NOTE:

In accordo alla UNI EN 13828 in presenza di acque aggressive per la lega di ottone, in ottemperanza alla UNI EN ISO 6509, è necessario l'utilizzo della lega di ottone CW602N. La produzione è disponibile su richiesta.

Le valvole a sfera della serie LOGIC sono realizzate in conformità alla EN 13828.

CHARACTERISTICS

Heavy series, full bore, long threads.
Perfect tightness at low and high pressure.
Long life with no maintenance.

THREADS

Threaded ends UNI EN 10226 (ex UNI 7/1).

USES

The **LOGIC** ball valves are suitable for hot and cold water, compressed air, oils and hydrocarbons in general.

For special uses please see the chemical resistance tables.

WORKING PRESSURE

From PN 80 (size 1/4") to PN 16 (size 4").

See pressure/temperature diagram.

TEMPERATURE LIMITS

From -20°C to +140°C.

See pressure/temperature diagram.

NOTE:

According to UNI EN 13828 in presence of water which could be aggressive for brass alloy, as agree with UNI EN ISO 6509 standard, is necessary the brass alloy CW602N. The manufacture is available on request.

LOGIC ball valves are manufactured in accordance with EN 13828 standard.

Diagramma pressione/temperatura Pressure/temperature diagram



Diagramma perdite di carico Head loss diagram



LOGIC

Valvola a sfera a passaggio totale serie pesante Heavy line full bore ball valve

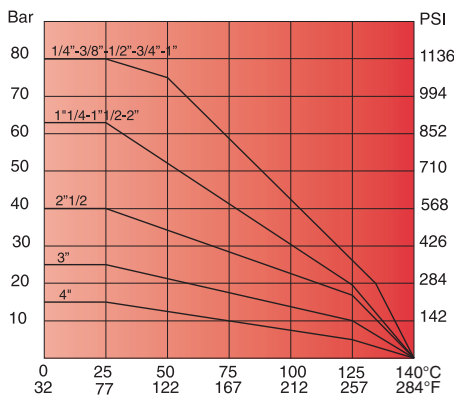
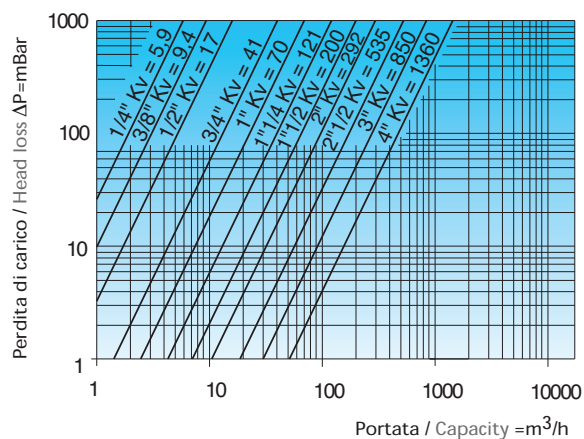
Art. S.0191 LOGIC

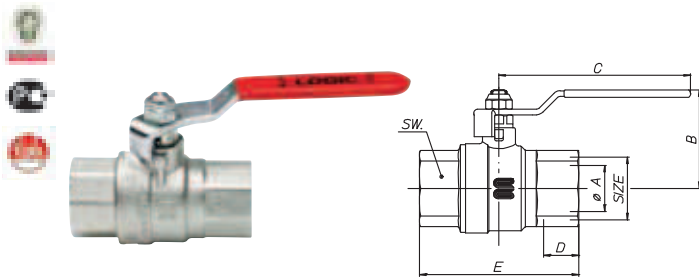

Valvola a sfera a passaggio totale con leva ferro, femmina/femmina, serie pesante, nichelata.
Full bore ball valve with steel handle, female/female, heavy line, nickel-plated.

SIZE	¼"	¾"	½"	¾"	1"	1¼"	1½"	2"	2½"	3"	4"
øA pass./bore	10	10	15	20	25	32	40	50	65	80	100
B mm	38	38	42	49,5	53,5	63,5	72,5	84	102	113,5	135
C mm	90	90	90	105	105	120	140	170	170	250	250
D mm	11	11,4	15	16,3	19,1	21,4	21,4	25,7	30,2	33,3	39,3
E mm	47,5	49,5	65	73,5	86,5	101,5	111,5	132,5	158	182,5	219
SW mm	17	21	26	32	39	48	55	68	83	97	124
Peso/Weight gr.	140	153	258	404	633	1044	1608	2716	3526	5657	10663

Art. S.0192 LOGIC

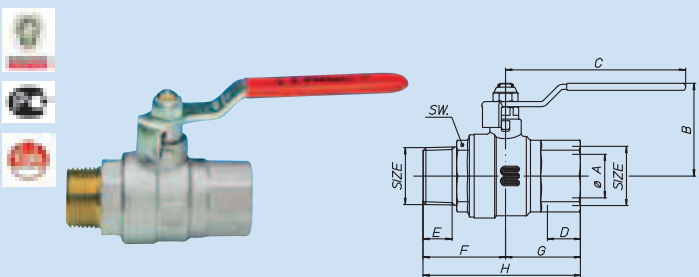

Valvola a sfera a passaggio totale con leva ferro, maschio/femmina, serie pesante, nichelata.
Full bore ball valve with steel handle, male/female, heavy line, nickel-plated.

SIZE	¼"	¾"	½"	¾"	1"	1¼"	1½"	2"		
øA pass./bore	10	10	15	20	25	32	40	50		
B mm	38	38	42	49,5	53,5	63,5	72,5	84		
C mm	90	90	90	105	105	120	140	170		
D mm	11	11,4	15	16,3	19,1	21,4	21,4	25,7		
E mm	9,7	10,1	13,2	14,5	16,8	19,1	19,1	23,4		
F mm	30,75	31,25	38	42,25	47,75	54,24	60,25	72,75		
G mm	23,75	24,75	32,5	36,75	43,25	50,75	55,75	66,25		
H mm	54,5	56	70,5	79	91	105	116	139		
SW mm	17	21	26	32	39	48	55	68		
Peso/Weight gr.	155	169	262	420	638	1069	1658	2752		

Art. S.0194 LOGIC

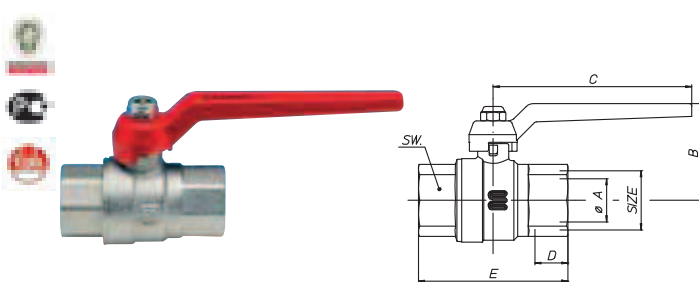

Valvola a sfera a passaggio totale con leva alluminio, femmina/femmina, serie pesante, nichelata.
Full bore ball valve with aluminium lever, female/female, heavy line, nickel-plated.

SIZE	¼"	¾"	½"	¾"	1"	1¼"	1½"	2"	2½"	3"	4"
øA pass./bore	10	10	15	20	25	32	40	50	65	80	100
B mm	39,5	39,5	41,5	51	55	64,5	75,5	87,5	108	119,5	142
C mm	80	80	95	115	115	130	150	170	170	235	235
D mm	11	11,4	15	16,3	19,1	21,4	21,4	25,7	30,2	33,3	39,3
E mm	47,5	49,5	65	73,5	86,5	101,5	111,5	132,5	158	181,5	219
SW mm	17	21	26	32	39	48	55	68	83	97	124
Peso/Weight gr.	122	135	250	380	612	1010	1579	2678	3484	5634	10640

Art. S.0195 LOGIC

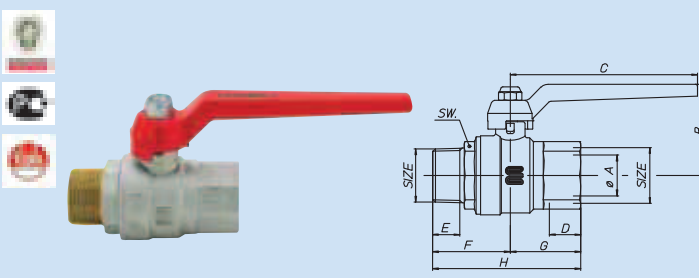

Valvola a sfera a passaggio totale con leva alluminio, maschio/femmina, serie pesante, nichelata.
Full bore ball valve with aluminium lever, male/female, heavy line, nickel-plated.

SIZE	¼"	¾"	½"	¾"	1"	1¼"	1½"	2"		
øA pass./bore	10	10	15	20	25	32	40	50		
B mm	39,5	39,5	41,5	51	55	64,5	75,5	87,5		
C mm	80	80	95	115	115	130	150	170		
D mm	11	11,4	15	16,3	19,1	21,4	21,4	25,7		
E mm	9,7	10,1	13,2	14,5	16,8	19,1	19,1	23,4		
F mm	30,75	31,25	38	42,25	47,75	54,25	60,25	72,75		
G mm	23,75	24,75	32,5	36,75	43,25	50,75	55,75	66,25		
H mm	54,5	56	70,5	79	91	105	116	139		
SW mm	17	21	26	32	39	48	55	68		
Peso/Weight gr.	137	151	250	399	617	1035	1440	2714		

Art. S.0197 LOGIC

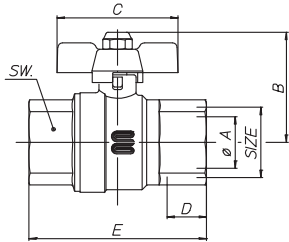
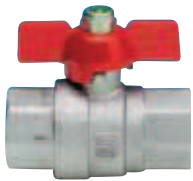

Valvola a sfera a passaggio totale con farfalla, femmina/femmina, serie pesante, nichelata.
Full bore ball valve with T-handle, female/female, heavy line, nickel-plated.

SIZE	1/4"	3/8"	1/2"	3/4"	1"				
øA pass./bore	10	10	15	20	25				
B mm	33,75	33,75	40,5	49,2	53,2				
C mm	52	52	52	65	65				
D mm	11	11,4	15	16,3	19,1				
E mm	47,5	49,5	65	73,5	86,5				
SW mm	17	21	26	32	39				
Peso/Weight gr.	117	130	236	370	599				

Art. S.0198 LOGIC

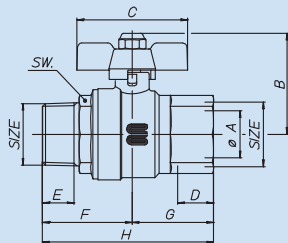
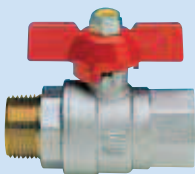
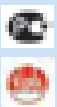

Valvola a sfera a passaggio totale con farfalla, maschio/femmina, serie pesante, nichelata.
Full bore ball valve with T-handle, male/female, heavy line, nickel-plated.

SIZE	1/4"	3/8"	1/2"	3/4"	1"				
øA pass./bore	10	10	15	20	25				
B mm	33,75	33,75	40,5	49,2	53,2				
C mm	52	52	52	65	65				
D mm	11	11,4	15	16,3	19,1				
E mm	9,7	10,1	13,2	14,5	16,8				
F mm	30,75	31,25	38	42,25	47,75				
G mm	23,75	24,75	32,5	36,75	43,25				
H mm	54,5	56	70,5	79	91				
SW mm	17	21	26	32	39				
Peso/Weight gr.	132	146	240	386	604				

Art. S.0450 LOGIC•BRAVO

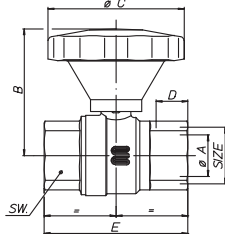

Valvola a sfera a passaggio totale con manopola di riduzione BRAVO, femmina/femmina, nichelata.
Full bore ball valve with BRAVO gear handle, female/female, nickel-plated.

SIZE	1/4"	3/8"	1/2"	3/4"	1"	1 1/4"	1 1/2"	2"	
øA pass./bore	10	10	15	20	25	32	40	50	
B mm	67	67	70,5	76	80	116	123	131,5	
øC mm	82	82	82	82	82	128	128	128	
D mm	11	11,4	15	16,3	19,1	21,4	21,4	25,7	
E mm	47,5	49,5	65	73,5	86,5	101,5	111,5	132,5	
SW mm	17	21	26	32	39	48	55	68	
Peso/Weight gr.	184	197	302	428	657	1218	1760	2840	

Art. S.0454 LOGIC•XT

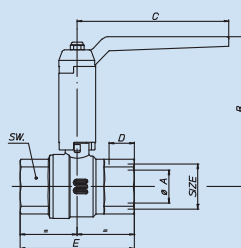
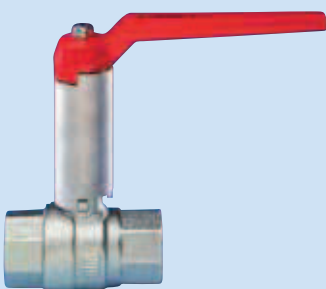

Valvola a sfera a passaggio totale con prolunga XT serie pesante, femmina/femmina, nichelata.
Full bore ball valve with extended stem, female/female, nickel-plated.

SIZE	1/4"	3/8"	1/2"	3/4"	1"	1 1/4"	1 1/2"	2"	2 1/2"	3"	4"
øA pass./bore	10	10	15	20	25	32	40	50	65	80	100
B mm	96,5	96,5	98,5	109,5	113,5	123	133	145	164,5	176	197,5
C mm	80	80	95	115	115	130	150	170	170	235	235
D mm	11	11,4	15	16,3	19,1	21,4	21,4	25,7	30,2	33,3	39,3
E mm	47,5	49,5	65	73,5	86,5	101,5	111,5	132,5	158	181,5	219
SW mm	17	21	26	32	39	48	55	68	83	97	124
Peso/Weight gr.	203	216	326	484	713	1160	1747	2925	3723	6366	11562